

Part number

# CRM D



Coding pin, for standard inserts, male, in zinc plated iron

#### Product description

<b>Product type</b>	Coding pin
<b>Specification</b>	For standard inserts Male, in zinc plated iron

#### Further technical details

<b>Weight</b>	1,70 g
---------------	--------

#### General ordering information

<b>EAN13 code</b>	8015747038737
<b>eCl@ss 8.1</b>	27440203
<b>ETIM 7.0</b>	EC002311

#### Packaging Information

<b>Packaging length</b>	112,00 mm
<b>Packaging height</b>	95,00 mm
<b>Packaging width</b>	117,00 mm
<b>Packaging weight</b>	0,89 kg
<b>Packaging volume</b>	1,24 dm <sup>3</sup>
<b>Packaging description</b>	Carton box
<b>Packaging quantity</b>	400 Pcs
<b>Packaging EAN code</b>	8015747206778
<b>Sub-packaging length</b>	50,00 mm
<b>Sub-packaging height</b>	44,00 mm
<b>Sub-packaging width</b>	50,00 mm
<b>Sub-packaging weight</b>	0,11 kg
<b>Sub-packaging volume</b>	0,11 dm <sup>3</sup>
<b>Sub-packaging description</b>	Plastic box
<b>Sub-packaging quantity</b>	50 Pcs
<b>Sub-packaging EAN barcode</b>	8015747207980

Part number

# CRM D



## Catalogue drawings

### CRM / CRM D

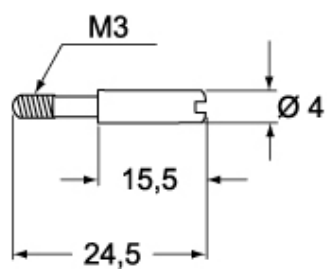

### CRF /CRF D

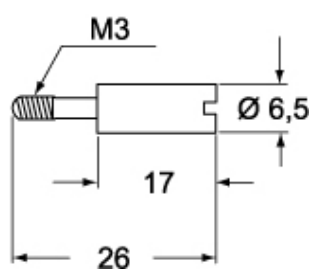

## Notes

Dimensions shown in mm are not binding and may be changed without notice.

---