

## Limit switches

OsiSense XC Standard

Compact design, plastic, type XCK P

Complete switches with 1 cable entry

1

ZCP 2● + ZCP EP16/ZCP 3● + ZCP EP16

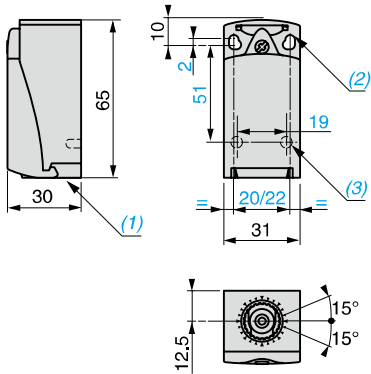

ZCE 10

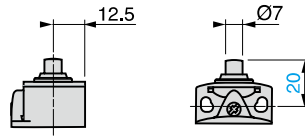

ZCE 11

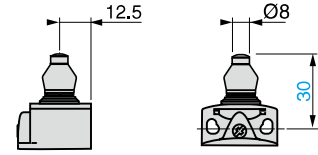

ZCE 02

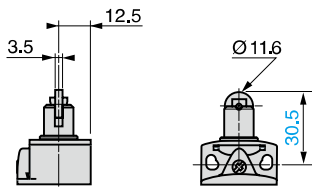

ZCE 21

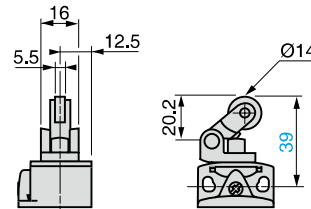

ZCE 27

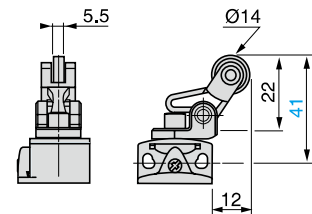

ZCE 28

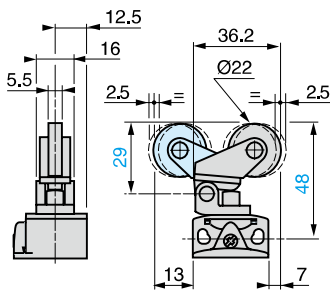

ZCE H0

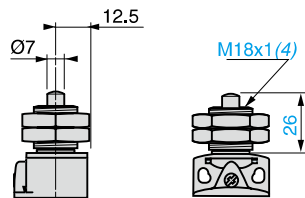

ZCE H2

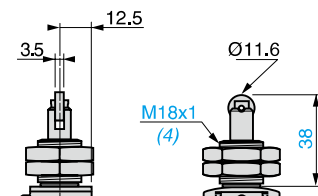

- (1) Tapped entry for ISO M16 x 1.5 or Pg 11 cable gland.
- (2) 2 elongated holes  $\varnothing 4.3 \times 6.3$  mm on 22 mm centres, 2 holes  $\varnothing 4.3$  on 20 mm centres.
- (3) 2 x  $\varnothing 3$  holes for support studs, depth 4 mm.
- (4) Fixing nut thickness 3.5 mm.

# Limit switches

OsiSense XC Standard

Compact design, plastic, type XCK P

Complete switches with 1 cable entry

ZCE 01 + ZCY 18

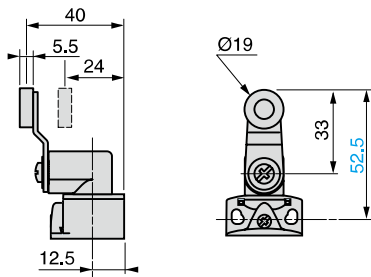

ZCE 01 + ZCY 45

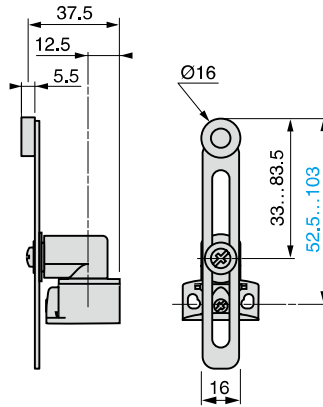

ZCE 01 + ZCY 39

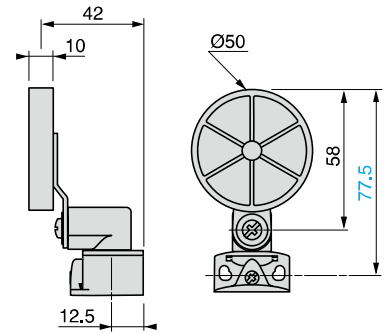

ZCE 01 + ZCY 49

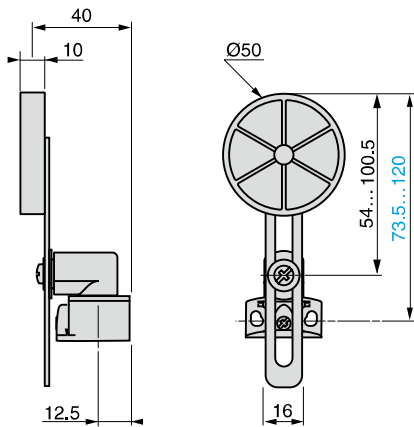



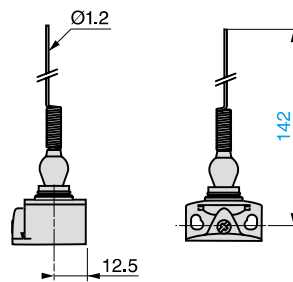







ZCE 06

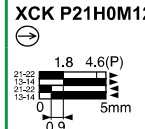

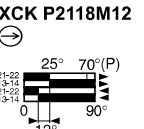
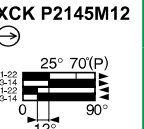
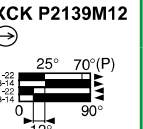
1

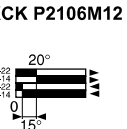
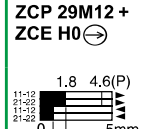
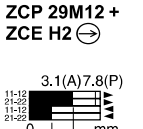
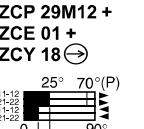
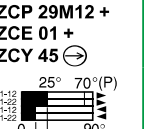
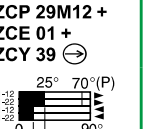
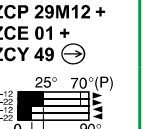
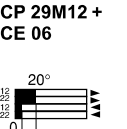

Type of head	Plunger (fixing by the head)		Rotary (fixing by the body)				Multi-directional
			Form A (1)				
Type of operator	M18 with metal end plunger	M18 with steel roller plunger	Thermoplastic roller lever	Variable length thermoplastic roller lever	Thermoplastic roller lever, Ø 50 mm	Variable length thermoplastic roller lever, Ø 50 mm	"Cat's whisker" (2)

References							
<b>2-pole NC + NO snap action (XE2S P2151)</b>	<b>XCK P21H0M12</b> 	<b>XCK P21H2M12</b> 	<b>XCK P2118M12</b> 	<b>XCK P2145M12</b> 	<b>XCK P2139M12</b> 	<b>XCK P2149M12</b> 	<b>XCK P2106M12</b> 
<b>2-pole NC + NC snap action (XE2S P2141)</b>	<b>ZCP 29M12 + ZCE H0</b> 	<b>ZCP 29M12 + ZCE H2</b> 	<b>ZCP 29M12 + ZCE 01 + ZCY 18</b> 	<b>ZCP 29M12 + ZCE 01 + ZCY 45</b> 	<b>ZCP 29M12 + ZCE 01 + ZCY 39</b> 	<b>ZCP 29M12 + ZCE 01 + ZCY 49</b> 	<b>ZCP 29M12 + ZCE 06</b> 
<b>Weight (kg)</b>	0.140	0.140	0.140	0.150	0.155	0.160	0.090
<b>Contact operation</b>	 closed  open		(A) = cam displacement (P) = positive opening point		 NC contact with positive opening operation		

(1) Form conforming to EN 50047, see page 1/176.  
(2) Value taken with actuation by moving part at 100 mm from the fixing.

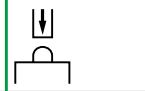
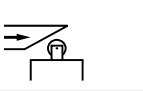
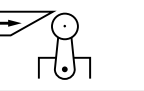
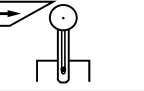
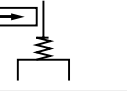
Characteristics					
<b>Switch actuation</b>	On end	By 30° cam			By any moving part
<b>Type of actuation</b>					
<b>Maximum actuation speed</b>	0.5 m/s	1.5 m/s			1 m/s (any direct.)
<b>Mechanical durability (in millions of operating cycles)</b>	10				5
<b>Minimum force or torque</b>	For tripping For positive opening	15 N 45 N	10 N 36 N	0.1 N.m 0.25 N.m	0.13 N.m -
<b>Connection</b>	M12 connector, Ui = 250 V, Ie = 3 A maximum, lth = 3 A				

### Dimensions

