

Starters for Fluorescent Lamps

Product information

GE's environmentally friendly, premium quality glow switch starters are designed to reliably ignite fluorescent lamps coupled with conventional electromagnetic gears. These starters are also recommended for use with GE T8 LongLast™ lamps due to their improved durability, ensuring safe operation over an extended period.

Features

- Lead free glass component
- Radioactive free design
- Outstanding reliability – up to 10,000 switches
- Flame-retardant plastic canister for safety
- Reliable operation in a wide ambient temperature range
- ENEC-certified



Product range

| Fluorescent Lamp Wattages | | | | | | | | | | | | | | Product Designation | Product Code | |
|--|--------|--------|--------|-----|--------|-----|--------|-----------|-----|-----|-----|----------|------|---------------------|--------------|-------|
| 4/6/8W | 10/13W | 15/16W | 18/20W | 22W | 30/32W | 38W | 36/40W | 58/65/80W | 70W | 75W | 85W | 100/115W | 125W | | | |
| Single operation on 220-240V | | | | | | | | | | | | | | | | |
| ✓ | ✓ | ✓ | ✓ | ✓ | ✓ | ✓ | ✓ | ✓ | | | | | | | 155/501 | 36536 |
| | | | | | | | | | ✓ | ✓ | ✓ | ✓ | ✓ | | 155/800 | 37864 |
| | | | | | | | | | ✓ | ✓ | ✓ | ✓ | | | 155/801 | 37975 |
| Series operation on 220-240V/Single operation on 110-120V | | | | | | | | | | | | | | | | |
| ✓ | | ✓ | ✓ | ✓ | | | | | | | | | | | 155/200 | 36711 |

Packed in 25/250 boxes, but also available in bulk pack.



Basic data

| GE Code | 155/200 | 155/501 | 155/800 | 155/801 |
|--|-----------------------|-----------------------|-----------------------|-----------------------|
| Operating Frequency [Hz] | 50 | 50 | 50 | 50 |
| Input Voltage – Single [V] | 110-120 | 220-240 | 220-240 | 220-240 |
| Input Voltage – Series [V] | 220-240 | - | - | - |
| Peak Voltage (New Starters – Stored in Dark) [V] | Min. 800 | Min. 900 | Min. 900 | Min. 900 |
| Non-Reclosure Voltage (New Starters – Stored in Dark) [V] | Max. 70 | Max. 140 | Max. 180 | Max. 170 |
| Starting Ambient Temperature Range [°C] | -15 to +60 | -15 to +60 | -15 to +60 | -15 to +60 |
| Endurance Performance – Switching | 10,000 | 10,000 | 6,000 | 6,000 |
| Contact Pins Material | Aluminium | Aluminium | Aluminium | Aluminium |
| Cannister | UV and Heat Resistant | UV and Heat Resistant | UV and Heat Resistant | UV and Heat Resistant |
| Safety | Comply with IEC | Comply with IEC | Comply with IEC | Comply with IEC |
| RoHS Compliance | Yes | Yes | Yes | Yes |
| Radioactive Material Content | None | None | None | None |

Dimensions

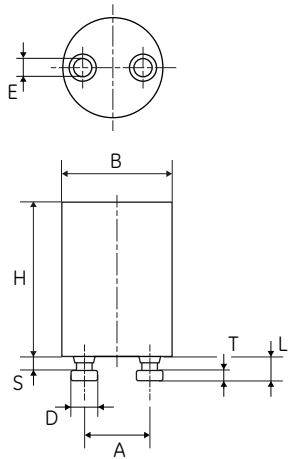

| | Min. [mm] | Max. [mm] |
|---|-----------|-----------|
| A | 12.5 | 12.9 |
| B | - | 21.5 |
| D | 4.7 | 5.0 |
| E | 2.8 | 3.2 |
| H | 33.0 | 36.0 |
| L | - | 4.3 |
| S | 1.7 | - |
| T | 1.9 | 2.2 |