

# CAB 3™ marking system

markers for wiring and Viking 3 terminal blocks



Perfect alignment of label holders



0 382 12

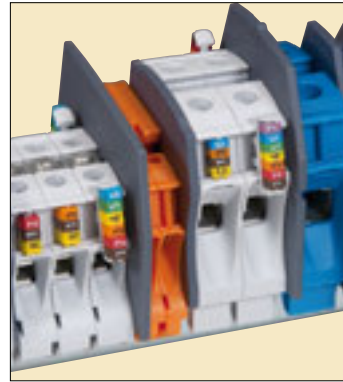

Terminal block with CAB 3 markers and label-holders

For marking wiring or Viking 3 terminal blocks

Pack	Cat.Nos		<b>Markers for wiring 0.15 to 0.5 mm<sup>2</sup> and 0.5 to 1.5 mm<sup>2</sup> cross-section and terminal blocks</b> On Viking 3 terminal blocks - 4 markers 0.15 to 0.5 mm <sup>2</sup> max - 3 markers 0.5 to 1.5 mm <sup>2</sup> max. Pack: - Up to 0.5 mm <sup>2</sup> : strips of 25 markers From 0.5 mm <sup>2</sup> to 2.5 mm <sup>2</sup> : strips of 30 markers Price per marker <b>Digits: international colour code</b> 0 Black 1 Brown 2 Red 3 Orange 4 Yellow 5 Green 6 Blue 7 Purple 8 Grey 9 White <b>Letters: black on yellow background</b> A B C D E F G H I J K L M N O P Q R S T U V W X Y Z <b>Conventional symbols: black on yellow background</b> / • + - ~ = ±
1000 1200	0 381 00	0 382 10	
1000 1200	0 381 01	0 382 11	
1000 1200	0 381 02	0 382 12	
1000 1200	0 381 03	0 382 13	
1000 1200	0 381 04	0 382 14	
1000 1200	0 381 05	0 382 15	
1000 1200	0 381 06	0 382 16	
1000 1200	0 381 07	0 382 17	
1000 1200	0 381 08	0 382 18	
1000 1200	0 381 09	0 382 19	
300	0 381 10	0 383 00	A
300	0 381 11	0 383 01	B
300	0 381 12	0 383 02	C
300	0 381 13	0 383 03	D
300	0 381 14	0 383 04	E
300	0 381 15	0 383 05	F
300	0 381 16	0 383 06	G
300	0 381 17	0 383 07	H
300	0 381 18	0 383 08	I
300	0 381 19	0 383 09	J
300	0 381 20	0 383 10	K
300	0 381 21	0 383 11	L
300	0 381 22	0 383 12	M
300	0 381 23	0 383 13	N
300	0 381 24	0 383 14	O
300	0 381 25	0 383 15	P
300	0 381 26	0 383 16	Q
300	0 381 27	0 383 17	R
300	0 381 28	0 383 18	S
300	0 381 29	0 383 19	T
300	0 381 30	0 383 20	U
300	0 381 31	0 383 21	V
300	0 381 32	0 383 22	W
300	0 381 33	0 383 23	X
300	0 381 34	0 383 24	Y
300	0 381 35	0 383 25	Z
300	0 381 40	0 382 70	/
300	0 381 41	0 382 71	•
300	0 381 42	0 382 72	+
300	0 381 43	0 382 73	-
300	0 381 44	0 382 74	~
300	0 381 45	0 382 75	=
300	0 381 46	0 382 76	±

Pack	Cat.Nos		<b>Markers for wiring 1.5 to 2.5 mm<sup>2</sup> and 4 to 6 mm<sup>2</sup> cross-section</b> Pack: From 0.5 mm <sup>2</sup> to 2.5 mm <sup>2</sup> : strips of 30 markers - Upper 2.5 mm <sup>2</sup> : strips of 20 markers Price per marker <b>Digits: international colour code</b> 0 Black 1 Brown 2 Red 3 Orange 4 Yellow 5 Green 6 Blue 7 Purple 8 Grey 9 White <b>Letters: black on yellow background</b> A B C D E F G H I J K L M N O P Q R S T U V W X Y Z <b>Conventional symbols: black on yellow</b> / • + - ~ = ±
1200 800	0 382 20	0 382 30	
1200 800	0 382 21	0 382 31	
1200 800	0 382 22	0 382 32	
1200 800	0 382 23	0 382 33	
1200 800	0 382 24	0 382 34	
1200 800	0 382 25	0 382 35	
1200 800	0 382 26	0 382 36	
1200 800	0 382 27	0 382 37	
1200 800	0 382 28	0 382 38	
1200 800	0 382 29	0 382 39	
300	0 383 30	0 383 60	A
300	0 383 31	0 383 61	B
300	0 383 32	0 383 62	C
300	0 383 33	0 383 63	D
300	0 383 34	0 383 64	E
300	0 383 35	0 383 65	F
300	0 383 36	0 383 66	G
300	0 383 37	0 383 67	H
300	0 383 38	0 383 68	I
300	0 383 39	0 383 69	J
300	0 383 40	0 383 70	K
300	0 383 41	0 383 71	L
300	0 383 42	0 383 72	M
300	0 383 43	0 383 73	N
300	0 383 44	0 383 74	O
300	0 383 45	0 383 75	P
300	0 383 46	0 383 76	Q
300	0 383 47	0 383 77	R
300	0 383 48	0 383 78	S
300	0 383 49	0 383 79	T
300	0 383 50	0 383 80	U
300	0 383 51	0 383 81	V
300	0 383 52	0 383 82	W
300	0 383 53	0 383 83	X
300	0 383 54	0 383 84	Y
300	0 383 55	0 383 85	Z
300	0 382 80	0 382 90	/
300	0 382 81	0 382 91	•
300	0 382 82	0 382 92	+
300	0 382 83	0 382 93	-
300	0 382 84	0 382 94	~
300	0 382 85	0 382 95	=
300	0 382 86	0 382 96	±

# CAB 3™ marking system accessories



## Pack Cat.Nos CAB 3 accessories

Pack	Cat.Nos	Description
		<b>Marker-holders</b>
		For cables cross-section from 10 mm <sup>2</sup> to 70 mm <sup>2</sup> Capacity: 8 digits, letters or symbols markers from 0.5 to 1.5 mm <sup>2</sup> or 1.5 to 2.5 mm <sup>2</sup> cross section Black
100	0 384 90	10 to 16 mm <sup>2</sup> cross-section
50	0 384 91	25 to 35 mm <sup>2</sup> cross-section
50	0 384 92	50 to 70 mm <sup>2</sup> cross-section
		<b>Support for markers</b>
100	0 383 92	Can be clipped on Viking 3 terminal blocks Capacity: 7 markers from 0.15 to 0.5 mm <sup>2</sup> 6 markers from 0.5 to 1.5 mm <sup>2</sup>
		<b>Transparent applicators</b>
		For rapid selection and application of markers onto cable
		For markers cross-section (mm <sup>2</sup> )
10	0 383 94	0.15 to 0.5
10	0 383 95	0.5 to 1.5
10	0 383 96	1.5 to 2.5
10	0 383 97	4 to 6
		Applicator colour for identification of cross-section
		green
		red
		blue
		yellow
		<b>Set of markers (digits)</b>
1	0 382 01	0.15 to 0.5 mm <sup>2</sup> : 2500 markers + 10 applicators (250 digits from 0 to 9)
1	0 382 02	0.5 to 1.5 mm <sup>2</sup> : 3000 markers + 10 applicators (300 digits from 0 to 9)
1	0 382 03	1.5 to 2.5 mm <sup>2</sup> : 3000 markers + 10 applicators (300 digits from 0 to 9)
1	0 382 04	4 to 6 mm <sup>2</sup> : 2000 markers + 10 applicators (200 digits from 0 to 9)
		<b>On-site toolbox</b>
1	0 382 00	With removable tray for CAB 3 markers and applicators, Starfix ferrules... Height 85 mm, depth 280 mm, width 450 mm Metal, padlockable Supplied empty

# CAB 3™ marking system for wiring and Viking 3 terminal blocks

## ■ Dimensions

### Markers

Polyamide 6/6

Dimensions	Cable cross-section (mm <sup>2</sup> )			
	0.15 to 0.5	0.5 to 1.5	1.5 to 2.5	4 to 6
A (mm)	5	5	5.6	8
B (mm)	5.05	6.4	7.6	9.6
C (mm)	3.7	4.3	4.9	7.1
D (mm)	2.3	3	3	3
Ø mini/maxi (mm)	0.8/2.2	2.2/3	2.8/3.8	4.3/5.3

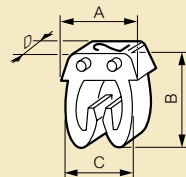

Cat.Nos 0 381 50 to 0 381 55 et 0 381 60 to 0 381 65: no liking stud.  
D = 6 mm

### Marker holders

Cat.No 0 384 90

Cat.No 0 384 91

Cat.No 0 384 92

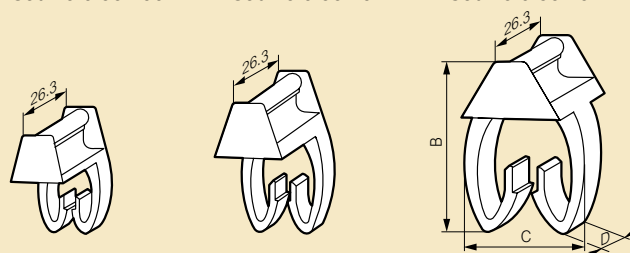

Dim.	Section of cable for marking (mm <sup>2</sup> )		
	10 to 16	25 to 35	50 to 70
B (mm)	18	24.3	27.2
C (mm)	8.9	12.2	17.2
D (mm)	7	7	10

### Support for markers Cat.No 0 383 92

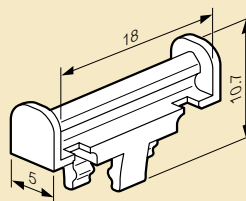

## ■ Characteristics and dimensions of on-site toolbox

Cat.No 0 382 00

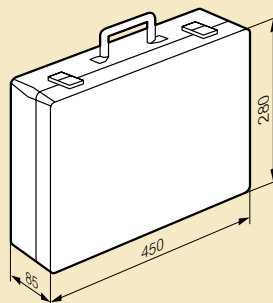

Bottom tray consists of:

- 8 medium slots (around 8 CAB 3 boxes)
- 1 large slot

Top tray consists of:

- 12 small slots (<=> approx. 6 boxes of CAB 3)
- 1 medium slot for applicators

Capacity: approx. 15000 CAB 3 markers

## ■ Examples

On terminal blocks with support Cat.No 0 383 92



On power terminal blocks

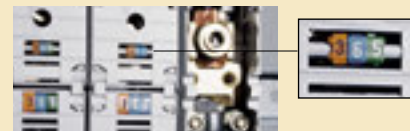

On cable with marker-holder Cat.No 0 384 92

