

1. Introduction

The CT241 telephone controller is designed to remotely control up to four independent loads.

For example, you could connect a sprinkler system, a water heater, etc. Another example would be to connect an output to the thermostat's phone interface (which requires a dry contact) to switch from Comfort mode to Vacation mode and vice versa.

Loads can be activated or deactivated remotely (by telephone) or manually (on-site).

Figure 1: Product Overview

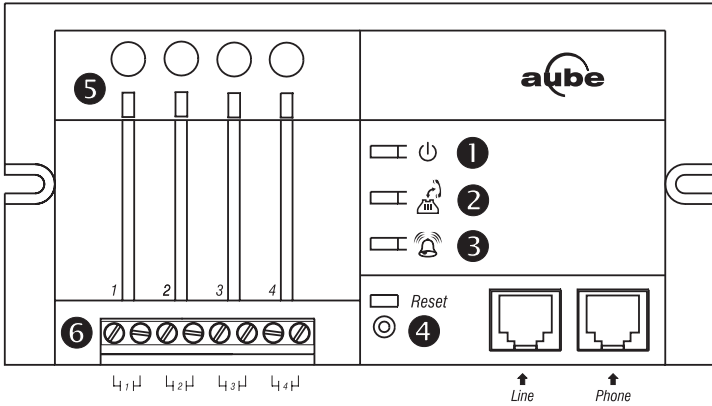

- 1 Power Indicator.** Indicates the CT241 is powered on. To turn it off, unplug the power transformer.
- 2 Communication Indicator.** Indicates the CT241 has answered and is awaiting a command.
- 3 Ring Indicator.** This indicator flashes when the phone rings.
- 4 Reset.** This button can be used to reset the CT241 to its default values. See section 3.2.
- 5 Manual Output Activation Button.** Can be used to manually activate or deactivate a relay.
- 6 Terminal Board.** See section 2.

2. Installation

Any device connected to a telephone line must conform to the country's standards. The CT241 telephone controller meets:

- FCC68 standards for installation on the North American network.
- FDTBR21 standards for installation on the European network.

2.1 Included Parts

- One CT241 telephone controller)
- One power transformer 120 V (North America) or 250 V (Europe)
- One 5 m (16 foot) telephone cable

2.2 Installation Procedure

NOTE: If you are using an answering machine, position the answering machine switch to ON before installing the CT241. Make sure that your answering machine answers after a minimum of 4 rings.

Figure 2: Answering Machine Switch

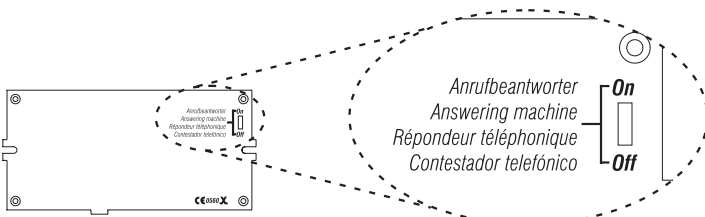
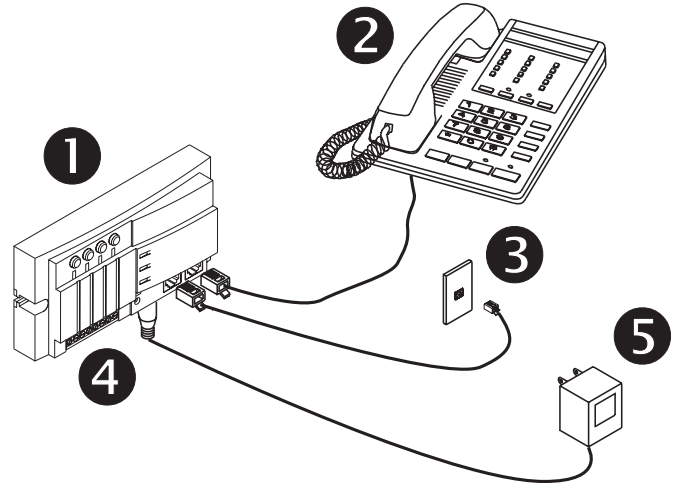

Figure 3: Typical Installation



- 1** Mount the CT241 near a telephone outlet.

NOTE: If you plan to connect a load having more than 30 volts on the auxiliary outputs, the CT241 must be installed inside a certified electrical box.

- 2** OPTIONAL. Connect your phone (or answering machine) to the PHONE connector of the CT241.
- 3** Connect one end of the telephone cable to the LINE connector of the CT241 and the other end to the telephone outlet in your home.
- 4** Connect the loads.

The four outputs of the CT241 allow you, for example, to activate or deactivate the lighting system, the sprinkler system, the water heater, etc.

You can also connect a thermostat's telephone interface (which requires a dry contact) to automatically switch from Comfort mode to Vacation mode and vice versa.

NOTE: The capacity per output is 10 A @ 240 VAC. However, to avoid electrical shocks, the direct connection of a load exceeding 30 VAC is not permitted unless the CT241 is installed inside a certified electrical box.

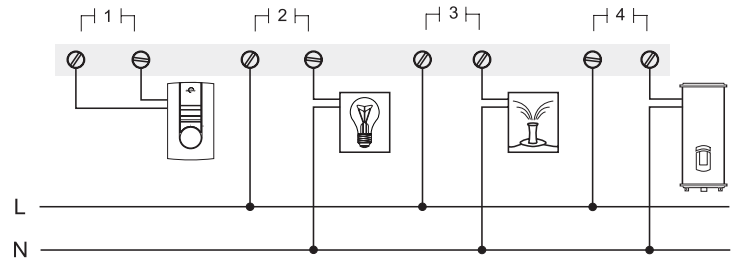

- 5** When all connections have been made, connect the power transformer to the 9 V outlet of the CT241 and the other end to the wall electrical outlet. The power indicator light is ON when the circuit is powered.

3. Operation

NOTE: The CT241 will automatically hang up if no key is pressed during the 30 seconds following the CT241 answering a call.

Default values: access code (1234), number of rings (4)

1 BEGIN A SESSION (without answering machine)

Dial your phone number

Wait for the number of rings...

CT241 answers



1 BEGIN A SESSION (with an answering machine)

Dial your phone number

Let it ring once and hang up

Wait 10 seconds...

Dial your phone number again within the next 30 seconds

CT241 answers (1st ring)



2 ENTER YOUR ACCESS CODE

Enter your 4-digit access code (default: 1234)



Accepted



Error

3 OUTPUT STATUS/MODIFY STATUS

Press the output's corresponding number (1, 2, 3, 4) for status



Deactivated (open)

Press * to change its status



Activated (closed)

3 MODIFY THE ACCESS CODE

Press # 8



Enter your new 4-digit access code



Enter the access code again



Accepted



Error

3 MODIFY THE NUMBER OF RINGS (phone only)

Press # 9



Enter the number of rings after which the CT241 will answer (between 1 and 9)

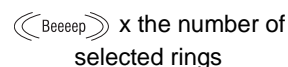

4 END SESSION

Press # 0 to end the session

3.1 Manual Output Activation Buttons

You can switch a relay status by pressing the corresponding input's button directly on the CT241.

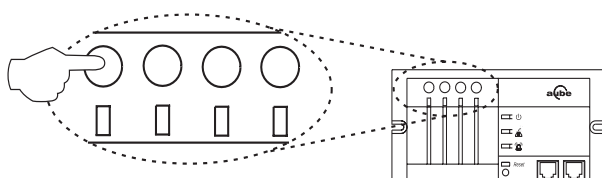

This function is not accessible while the CT241 is answering a telephone call.

3.2 Reset Operation

Insert a pointed object (e.g. paper clip) in the hole located under the Reset light. The light will flash 3 times to indicate that the CT241 has been reset:

- number of rings: 4
- access code: 1234
- relays' status: open

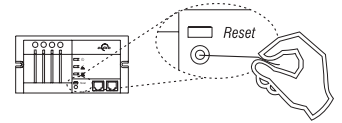

4. Technical Specifications

Power supply: 9 VAC / 60 Hz (50 Hz Europe)

Outputs: Four SPST with the following capacity:

- 5 A / 30 VAC inductive / Power Factor: 0.4
- 10 A / 30 VAC resistive (if installed in a certified electrical box)
- 10 A / 240 VAC resistive (if installed in a certified electrical box)
- 1/2 HP / 120 VAC motor (if installed in a certified electrical box)
- 1 HP / 240 VAC motor (if installed in a certified electrical box)

Protection: Class II

Access code (default): 1234

Number of rings (default): 4 rings

Memory protection: In case of power failure, access code and output status are protected.

Phone certification standard:

- FDTBR21: European telephone network
- FCC68: North American telephone network

Approvals:

- c UL us (North America)
- CE (Europe)

Dimensions (H W D): 2.7 x 5.4 x 1.2 in. (69 x 137 x 31 mm)

5. Warranty

AUBE TECHNOLOGIES INC. THREE (3) YEAR LIMITED WARRANTY

This product is guaranteed against workmanship defects for a three-year period following the initial date of purchase. During this period, AUBE Technologies Inc. will repair or replace, at our option and without charge, any defective product which has been used under normal conditions.

The warranty does not cover delivery costs and does not apply to products poorly installed or randomly damaged following installation.

This warranty cancels and replaces any other manufacturer's express or implied warranty as well as any other company commitment. AUBE Technologies Inc. cannot be held liable for related or random damages following the installation of this product.

The defective product as well as the purchase invoice must be returned to the place of purchase or mailed, prepaid and insured, to the nearest shipping address.



705 Montrichard
Saint-Jean-sur-Richelieu
Quebec, Canada J2X 5K8
Tel.: 1 (450) 358-4600
Toll Free: 1-800-831-AUBE
Fax: 1 (450) 358-4650
service@aubetech.com

10 Ampère Street
95500 Gonesse
France
33 (0) 1 34 07 99 00
33 (0) 1 34 07 99 19
advaube@comintes.com

For more information on our products, visit us at: www.aubetech.com