

760ES Radio Siren Installation Guide

Overview

The 760ES is an external, self powered, siren and strobe unit designed to work with the i-on range of control units.

Fitted within the enclosure are twin sounders capable of exceeding 100dB(A), a radio transceiver operating on 868MHz, a battery pack and a LED strobe strip. The unit can be mounted on any non-metallic vertical surface. The range of operation from the control unit may vary depending on the site conditions and in particular the material of walls between the two units. In free air the range will easily exceed 100m.

This product is suitable for use in systems designed to comply with EN 50131-1:2006 and PD6662:2004 +A1+A2 at Grade 2 and is tested to prEN 50131-4:2008 at Grade 2.

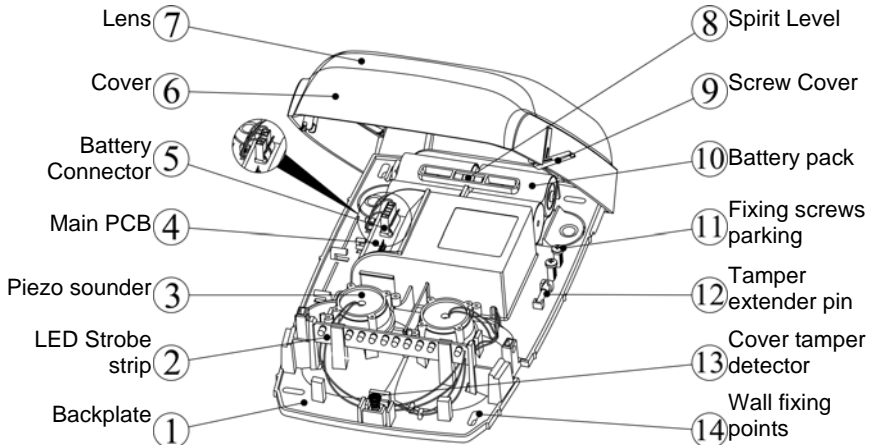

Features

- 105 dB(A)@1m sound output
- prEN 50131-4 Grade 2 Compliant
- High power LED strobe
- Cover and rear tamper detection
- Selectable cut-off timer
- Anti-jamming detection
- Conformally coated electronics
- Battery change warning
- Built in spirit level installation aid
- Choice of battery options
- Quiet installation mode
- Cover screen printing facility
- High impact resistant polycarbonate backplate and cover

Technical Specification

Sound Output	105 dBA@1m (tone)
Cut-off Timer	Selectable 5 secs, 3 mins, 15 mins
Environmental	EN 50130-5:1999 class IV
Operating temperature	-25°C to +60°C
Humidity	93% RH
Dimensions	212mm W, 346mm H, 76mm D
Weight	1.2 kg (without batteries)
Case material	Polycarbonate

Radio Supervision	Programmable at control unit.
Radio Section	Operating frequency 868.6625MHz Narrowband.
Transmitter range	100m depending on the installation environment.
Battery Packs	2 x 3V Alkaline or 1 x 7.2V Lithium*
Battery Life	Over two years for typical use*
Monitoring includes	Battery low voltage (<4.0V), RF Jamming.
*Lithium batteries are recommended if temperatures are regularly below 0°C.	

Compliance, EMC and Safety

This product complies with the following EU Directives:

R&TTE 1999/5/EC, EMC: 2004/108/EC, RoHS: 2002/95/EC, WEEE: 2002/96/EC

Configuration

At the siren

Key: Link FITTED



Link NOT Fitted



Jamming detected signal transmission <ul style="list-style-type: none"> The siren independently monitors for attempted jamming but does not self activate. Jamming On = Siren informs control unit (Default) Jamming Off = No action 	ON:	OFF:	
Tamper Self-Activation (SAB) Mode <ul style="list-style-type: none"> SAB On = Siren self triggers when tampered and informs control unit, stops when tamper switch closed, or stopped by control unit. (Default) SAB Off = Siren does not self trigger but informs control unit when tampered. Control unit makes decisions. 	ON:	OFF:	
Sounder automatic cut-off timer Siren will stop when commanded by the control unit or after the cut-off time selected by the position of the link. Default is 15 minutes. <i>The strobe is not affected by the cut-off (it stops after a maximum of 15 minutes)</i>	3 mins	15 mins	5 secs

At the control unit

The siren can show that setting or unsetting has finished by flashing of the strobe. Refer to the i-on *Installation and Programming Guide* for details.

Installation

Carry out a radio site survey using the 790r signal strength meter and test transmitter to check that reception is adequate at the proposed sites for the control unit and siren.

Site the siren:

- Upright (strobe at the bottom), with space around it to permit good radio reception.
- Out of reach of intruders or vandals.
- Where it can be seen and heard easily.

Do NOT site the siren:

- Within 1m of large metal structures, for example: metal doors or frames, water tanks, cars, fridges and freezers.
- Within 1m of mains wiring or metal water or gas pipes.
- Inside metal enclosures.
- Next to high voltage electrical or electronic equipment, particularly computers, photocopiers or other radios.

WARNING

When installing batteries in the siren it may momentarily emit a loud tone. This may startle you. Ensure that you cannot overbalance and fall, or drop the siren.

Opening the siren and fitting/removing batteries:

1. Rotate the screw covers to access the two cover retaining screws. Undo the cover retaining screws far enough to release the cover.
2. Hinge the cover upwards from the bottom and remove it.
3. Slide the two alkaline (3V) or single lithium (7.2V) battery pack(s) from the side into the battery holding area. Use the clips provided to retain the battery cables. Ensure the cables are fitted the correct way around.
4. Push the connectors on to the pins on the PCB.

CAUTION: Take care to use the correct connections to avoid damaging the batteries or siren.

5. To remove the batteries first unplug the connectors from the PCB and remove the cables from the clips. Then push on the flexible parts of the backplate to allow the batteries to slide out of their holders.
6. At the end of the product's life, the batteries must be removed from the product. Both the waste product and batteries must be separated from the domestic waste stream and disposed of via an appropriate approved WEEE disposal route in accordance with all national and local regulations.

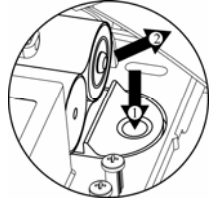
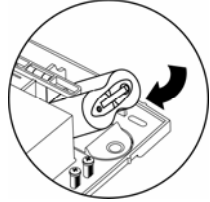
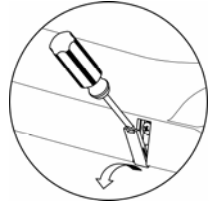
**Replacement Battery Part Nos.:**3V Alkaline: **760AB**7.2V Lithium: **760LB****Teaching the Siren to the Control Unit**

You must "teach" the identity of the siren to the control unit. For instructions see the i-on installation guide.

For "teaching", put the i-on into "installer mode", insert and connect the batteries (see above) and then operate the tamper detection switch at the bottom or back of the siren.

When attaching the cover make sure that you fit the tamper switch spring correctly (see right)

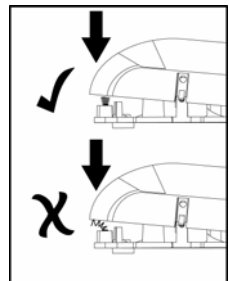

Note: Do not leave installer mode until you have fitted the siren in its final position. While in installer mode the siren will sound only in response to a test command. The siren

becomes fully active when you leave installer mode and depending on configuration may sound when a tamper switch is activated.

Physical Installation

Attach the siren to a solid non-metallic wall using suitable screws and wall fixing plugs. The fixing points are located in the four corners of the backplate.

To assist with levelling the siren there is a spirit level in the upper part (*Item 8 on diagram*).

Fit rear tamper extender (if required) and trim to desired length (*see below*).

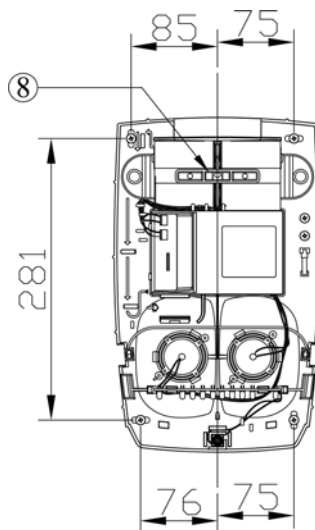
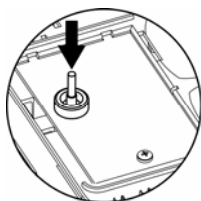

Maintenance

Test the sounder and strobe periodically for correct operation. During routine maintenance check the correct operation of cover and rear tampers. Check for signs of significant water or insect ingress and clean as necessary. Replace batteries every two years or when advised by the control unit.

Fault finding and diagnostics

The siren informs the control unit if its batteries have low voltage. The siren continues to self-actuate under tamper conditions even when radio communications to the control unit have been lost because of low battery voltage.

After installing, the siren will not sound until the control unit has left installer mode.

Changes in the environment (or deliberate jamming) may prevent radio transmission between the siren and control unit. The siren will try to inform the control unit when jamming is detected only if this feature is enabled using the configuration link.

***The packaging supplied with this product may be recycled.
Please dispose of packaging accordingly.***

Cooper Security Ltd
Security House
Vantage Point Business Village
Mitcheldean
Gloucestershire
GL17 0SZ
www.coopersecurity.co.uk
Product Support (UK) Tel: +44 (0) 1594 541979.
Available between:
08:15 and 17:00 Monday to Friday. Product Support Fax: (01594) 545401

